

5550 Granite Parkway

Office Center







# 5550 Granite Parkway Office Center

5550 Granite Parkway, Plano, Texas 75024

## PROJECT FEATURES:

- 74,234 SQ. FT. 2-STORY BUILDING
- 42 PRE-FINISHED HIGH QUALITY SUITES
- SUITE SIZES RANGE FROM 900 SQ.FT. UP TO 4,300 SQ.FT.
- SUITES ARE PRE-WIRED WITH VOICE AND DATA CABLING
- 300 PARKING SPACES
- COVERED PARKING AVAILABLE
- LOBBY CAFÉ WITH TENANT LOUNGE AREA
- TWO SHARED LOBBY CONFERENCE ROOMS WITH AUDIO/VIDEO AND WIFI
- 10' INTERIOR CEILINGS
- PROFESSIONALLY LANDSCAPED EXTERIOR
- IMMEDIATE ACCESS TO SH 121, DALLAS N TOLLWAY AND PRESTON ROAD
- EXCELLENT AREA DEMOGRAPHICS
- ADJACENT TO GRANITE AND LEGACY BUSINESS PARKS



[www.5550GRANITE.com](http://www.5550GRANITE.com)

DEVELOPED BY:  
MYERS & CROW COMPANY



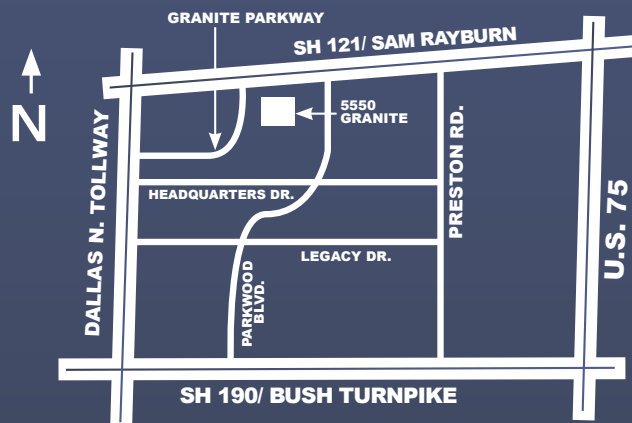
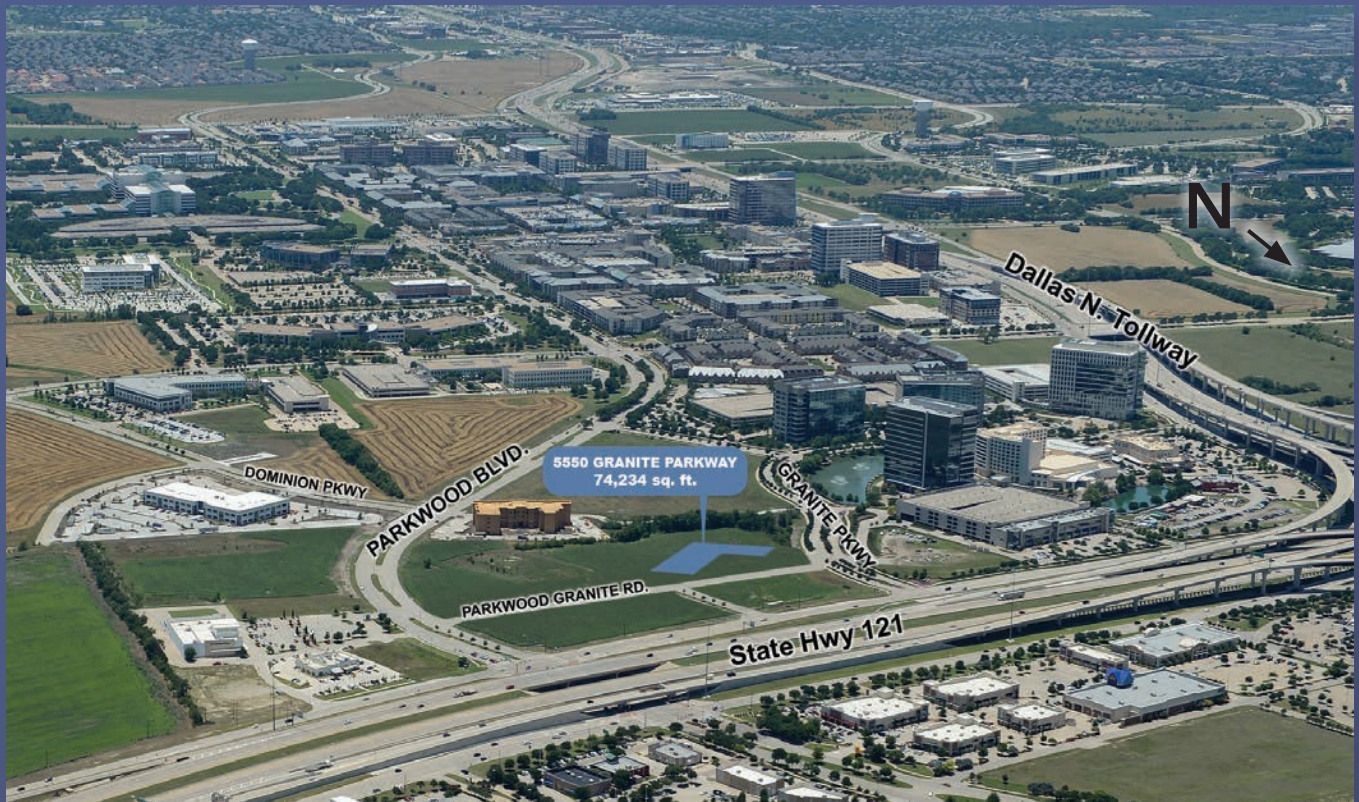

**PELTON**  
COMMERCIAL REAL ESTATE

FOR LEASING INFORMATION:  
TREVOR FRANKE [TFRANKE@PELTONCRE.COM](mailto:TFRANKE@PELTONCRE.COM)  
GINI DIBRELL [GDIBRELL@PELTONCRE.COM](mailto:GDIBRELL@PELTONCRE.COM)  
MATT PRUITT [MPRUITT@PELTONCRE.COM](mailto:MPRUITT@PELTONCRE.COM)  
**214.220.0600**